

Lead Safe™ Adjustable Flow Bubbler Outlet

PRODUCT CODES:

- 170.10.10.00

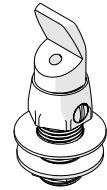

SPECIFICATIONS

- Fixed design.
- Robust construction for long life.
- Low maintenance.
- Finished in bright chrome plate for easy cleaning and durability.
- Lead Safe™ brass construction.

IMPORTANT: All bubblers are tested in accordance with AS/NZS 3718 and leave our premises in good working order.

Bubbler outlet only. Water activation device required (not supplied).

As 'lead free' is not currently defined by law in Australia and New Zealand, we have based our definition of Lead Safe™ on the requirements of s1417 of the USA's Safe Drinking Water Act (SDWA) and the relevant US standards NSF61 / NSF372. The SDWA defines 'lead free' as "not more than a weighted average of 0.25% lead when used with respect to the wetted surface of pipes, pipe fittings, plumbing fittings and fixtures".

TECHNICAL DATA

| | | |
|--------------------------------|-----------------|-----|
| Inlet | 1/2" BSP - Male | |
| Outlet | Bubbler | |
| Headwork | N/A | |
| Working Pressure Range (kPa) | Min | 50 |
| | Max | 500 |
| Working Temperature Range (°C) | Min | 5 |
| | Max | 60 |
| Nominal Flow Rate (LPM) | 1.6 | |
| Finish | Chrome | |

NOTE: Galvin Engineering continually strive to improve their products. Specifications may change without notice.

TOOLS REQUIRED

- Power drill
- Spanner or adjustable crescent
- Thread tape



PRE-INSTALLATION

MOUNTING DETAILS

- If the mounting hole does not already exist, mark out and drill the hole in the bench/trough, as shown in rough-in dimensions.

Note: Before installation, all lines must be flushed. We recommend that a line strainer be installed prior to eliminate any foreign material.

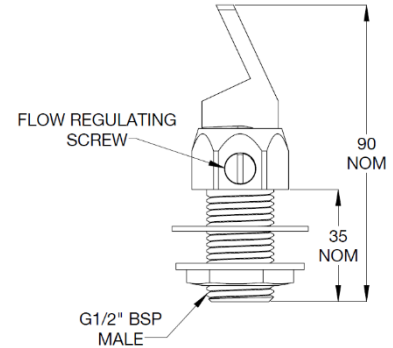
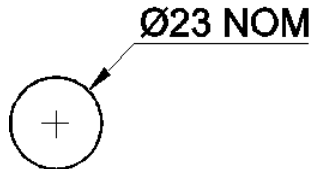

INSTALLATION

IMPORTANT: Galvin Engineering products must be installed in accordance with these installation instructions and in accordance with AS/NZS 3500, the PCA and your local regulatory requirements. Water and/or electrical supply conditions must also comply to the applicable national and/or state standards. Failing to comply with these provisions shall void the product warranty and may affect the performance of the product.

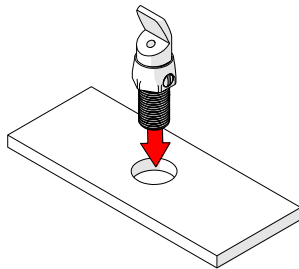

1. Fit Bubbler Outlet

- Fit the drinking outlet into the bench.

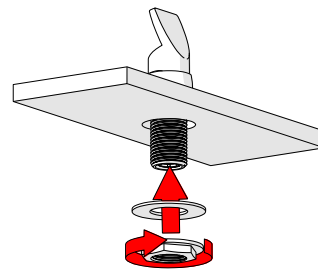

2. Secure the Bubbler Outlet

- Secure the bubbler outlet underneath with the supplied washer and back nut.

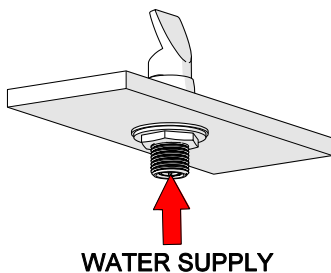

3. Connect

- Connect the outlet to the water supply.
- When applying thread tape or sealant to the inlet, ensure the opening is not obscured.

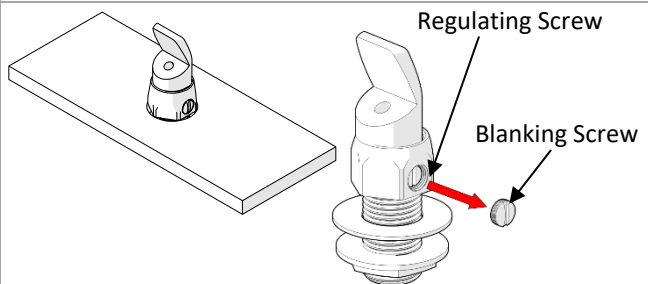

4. Testing

- Turn on the water supply and test for leaks.
- To adjust water flow:
 1. Remove the blanking screw
 2. Adjust the water height by turning the regulator screw
 3. Replace blanking screw.
- Note: The full range from minimum flow to maximum flow is only ¼ turn.



TROUBLESHOOTING

| PROBLEM | CAUSE | RECTIFICATION |
|-----------------------------------|---------------------|---|
| Incorrect flow | Flow not adjusted | Adjust flow to suit with side adjusting screw |
| Water is not flowing from the tap | Water is turned off | Turn on the water |

WARRANTY

The warranty set forth herein is given expressly and is the only warranty given by the Galvin Engineering Pty Ltd. With respect to the product, Galvin Engineering Pty Ltd makes no other warranties, express or implied. Galvin Engineering Pty. Ltd. hereby specifically disclaims all other warranties, express or implied, including but not limited to the implied warranties of merchantability and fitness for a particular purpose.

Galvin Engineering Pty Ltd products are covered under our manufacturer's warranty available for download from www.galvinengineering.com.au Galvin Engineering Pty Ltd expressly warrants that the product is free from operational defects in workmanship and materials for the warranty period as shown on the schedule in the manufacturer's warranty. During the warranty period, Galvin Engineering will replace or repair any defective products manufactured by Galvin Engineering without charge, so long as the terms of the Manufacturer's warranty are complied with.

The remedy described in the first paragraph of this warranty shall constitute the sole and exclusive remedy for breach of warranty, and Galvin Engineering Pty Ltd shall not be responsible for any incidental, special or consequential damages, including without limitation, lost profits or the cost of repairing or replacing other property which is damaged if this product does not work properly, other costs resulting from labour charges, delays, vandalism, negligence, fouling caused by foreign material, damage from adverse water conditions, chemical, electrical or any other circumstances over which Galvin Engineering has no control. This warranty shall be invalidated by any abuse, misuse, misapplication, improper installation or improper maintenance or alteration of the product.

